

# MODEL SP537V

## STANDARD CONSTRUCTION

- **Material:** Extruded Aluminum 6063-T6
- **Frame:** 5" (127 mm) Deep, 0.081" (2.1 mm) Wall Thickness
- **Blade:** 5" (127 mm) Deep, 0.080" (2.1 mm) Wall Thickness
- **Blade Spacing:** 1.25" (31.8 mm) On Center
- **Sill Flashing:** 0.063" (1.6 mm) Formed Aluminum W/ End Dams

## OPTIONAL ACCESSORIES

- Bird Screen - 1/2" x 0.063" Flattened Expanded Aluminum
- Insect Screen - 18 x 14 Mesh Charcoal Aluminum
- Extended Sill Flashing
- Insulated & Non-Insulated Blank Off Panels
- Hinged Access Panels

## FINISHES

- **2-Coat Fluoropolymer:** Fluoropon Pure® 70% PVDF (AAMA 2605)\*
- **3-Coat Fluoropolymer:** Fluoropon Pure® 70% PVDF (AAMA 2605)\*
- **Anodic Finishes:** Class I & Class II, Clear & Bronze Spectrum
- **Prime Coat:** Recommended When Field Painting

\*Fluoropon Pure® is Living Building Challenge Red List Free

\*Custom Colors Available

## SUGGESTED SPECIFICATIONS

- **General:** Furnish and install where indicated on drawings  
5" (127 mm) Storm Performance Louver Model SP537V as  
manufactured by Industrial Louvers, Inc. Delano, MN.
- **Material:** Extruded aluminum frames and blades shall be  
one piece 6063-T6 alloy, designed to collect and drain  
water to the exterior at the sill. Frame shall have a material  
thickness of 0.081" (2.1 mm). Fixed blades shall have a  
material thickness of 0.080" (2.1 mm). Frames and blades  
shall be joined by stainless steel fasteners.

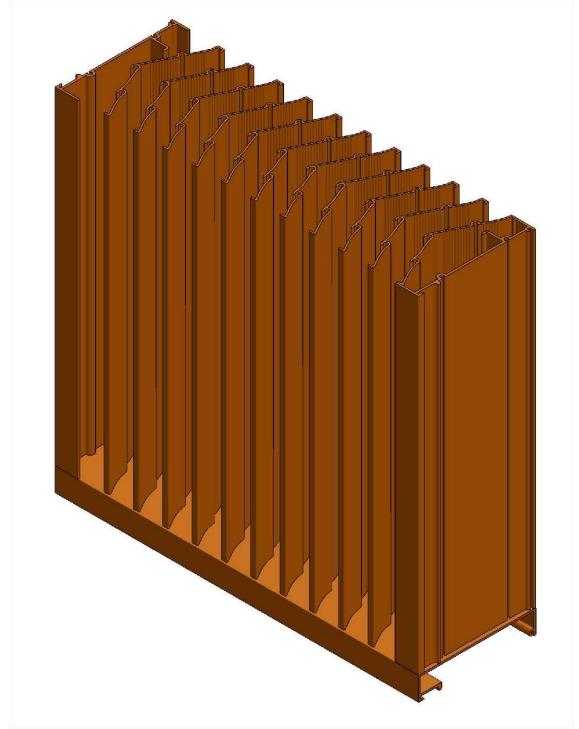

REV: MAY 2022



# MODEL SP537V

## PERFORMANCE

- Free Area = 10.33 ft<sup>2</sup> (64.5%)
  - Beginning of Water Penetration = 1250+ fpm / 12,912+ cfm
  - Air Flow @ ΔP of 0.15" Water = 957 fpm / 9885 cfm
- \*All Ratings Based on 48" x 48" Test Specimen  
 \*Ratings Include the Effect of a Sill Pan

FREE AREA (ft<sup>2</sup>)

| Louver Height | 120 in | 5.37  | 12.49 | 19.38 | 26.51 | 33.40 | 40.29 |
|---------------|--------|-------|-------|-------|-------|-------|-------|
|               | 108 in | 4.82  | 11.22 | 17.41 | 23.81 | 30.00 | 36.19 |
|               | 96 in  | 4.27  | 9.95  | 15.44 | 21.12 | 26.60 | 32.09 |
|               | 84 in  | 3.73  | 8.68  | 13.47 | 18.42 | 23.21 | 28.00 |
|               | 72 in  | 3.18  | 7.41  | 11.50 | 15.73 | 19.81 | 23.90 |
|               | 60 in  | 2.64  | 6.14  | 9.53  | 13.03 | 16.42 | 19.80 |
|               | 48 in  | 2.09  | 4.87  | 7.55  | 10.33 | 13.02 | 15.71 |
|               | 36 in  | 1.55  | 3.60  | 5.58  | 7.64  | 9.62  | 11.61 |
|               | 24 in  | 1.00  | 2.33  | 3.61  | 4.94  | 6.23  | 7.51  |
|               | 12 in  | 0.45  | 1.06  | 1.64  | 2.25  | 2.83  | 3.41  |
| Louver Width  | 12 in  | 24 in | 36 in | 48 in | 60 in | 72 in |       |

- Effects of blade stiffeners or additional bracing has not been considered.
- Effects of screen or other accessories has not been considered.
- Contact Industrial Louvers for free area of other sizes.
- 1 in = 25.4 mm
- 10.76 ft<sup>2</sup> = 1 m<sup>2</sup>

AIR PERFORMANCE

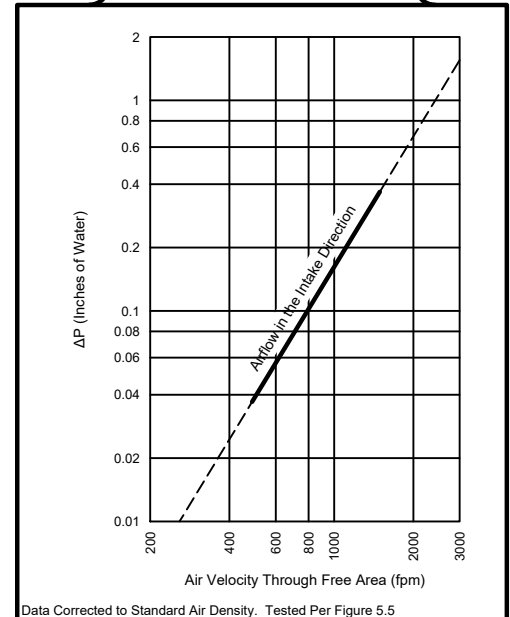

WIND DRIVEN RAIN

|                        | Ventilation Air Velocity | 0.0 m/s | 0.5 m/s | 1.0 m/s | 1.5 m/s | 2.0 m/s | 2.5 m/s | 3.0 m/s | 3.5 m/s |
|------------------------|--------------------------|---------|---------|---------|---------|---------|---------|---------|---------|
| Rainfall Rate: 3 in/hr | Core Velocity            | -       | -       | -       | -       | -       | -       | -       | 691 fpm |
| Wind Velocity: 29 mph  | Effectiveness            | -       | -       | -       | -       | -       | -       | -       | 100.0%  |
|                        | Penetration Class        | A       | A       | A       | A       | A       | A       | A       | A       |
| Rainfall Rate: 8 in/hr | Core Velocity            | -       | -       | -       | -       | -       | 490 fpm | 587 fpm | 688 fpm |
| Wind Velocity: 50 mph  | Effectiveness            | -       | -       | -       | -       | -       | 99.3%   | 99.3%   | 99.3%   |
|                        | Penetration Class        | A       | A       | A       | A       | A       | A       | A       | A       |

Discharge Loss Coefficient = 0.43 (Class 1)



Industrial Louvers, Inc. certifies that the Model SP537V shown herein is licensed to bear the AMCA Seal. The ratings shown are based on tests and procedures performed in accordance with AMCA Publication 511 and comply with the requirements of the AMCA Certified Ratings Program. The AMCA Certified Ratings Seal applies to air performance ratings, water penetration ratings, and wind driven rain ratings. © 2022 Industrial Louvers. All rights reserved.

REV: MAY 2022



www.IndustrialLouvers.com  
 ilinfo@IndustrialLouvers.com

511 South 7th Street, Delano MN 55328  
 Tel: 763.972.2981 | Fax: 763.972.2911



# MODEL SP537V

## STANDARD CONSTRUCTION

- **Material:** Extruded Aluminum 6063-T6
- **Frame:** 5" (127 mm) Deep, 0.081" (2.1 mm) Wall Thickness
- **Blade:** 5" (127 mm) Deep, 0.080" (2.1 mm) Wall Thickness
- **Blade Spacing:** 1.25" (31.8 mm) On Center
- **Sill Flashing:** 0.063" (1.6 mm) Formed Aluminum W/ End Dams

## OPTIONAL ACCESSORIES - Mark All Required Options

- Bird Screen - 1/2" x 0.063" Flattened Expanded Aluminum
- Insect Screen - 18 x 14 Mesh Charcoal Aluminum
- Extended Sill Flashing
- Insulated & Non-Insulated Blank Off Panels
- Hinged Access Panels

## FINISHES - Select One

- **2-Coat Fluoropolymer:** Fluoron Pure® 70% PVDF (AAMA 2605)\*
  - **3-Coat Fluoropolymer:** Fluoron Pure® 70% PVDF (AAMA 2605)\*
  - **Anodic Finishes:** Class I & Class II, Clear & Bronze Spectrum
  - **Prime Coat:** Recommended When Field Painting
  - **Mill Finish:** Bare Aluminum
- \*Fluoron Pure® is Living Building Challenge Red List Free  
\*Custom Colors Available

| Mark | Qty | Circle One: Louver Size / Rough Opening |        | Mullion Type (IVM or VVM) | Num. of Sections | Notes |
|------|-----|---|--------|---------------------------|------------------|-------|
|      |     | Width                                   | Height |                           |                  |       |
|      |     |   |        |                           |                  |       |
|      |     |   |        |                           |                  |       |
|      |     |   |        |                           |                  |       |
|      |     |   |        |                           |                  |       |
|      |     |   |        |                           |                  |       |

Please complete table above for quotation or immediate release to production. Indicate any required optional accessories and finishes listed above.

