



Industrial  
Louvers, Inc.

[www.IndustrialLouvers.com](http://www.IndustrialLouvers.com)

511 South 7th Street

Delano, MN 55328

763-972-2981

# Installation Instructions for Standard Canopy

**Note:**

- The information included in the submittal drawing package shall supersede any information included in these installation instructions. Fastener type, size, and quantity shall be dictated by the submittals. It is the responsibility of the installer to follow all building codes and comply with all safety regulations.
- These installation instructions are intended to cover basic standard canopy installation processes. Various surrounding conditions may require a specialized anchorage solution in which case the Industrial Louvers prepared shop drawings should be referenced for installation guidance.
- Anchors into substrate are not supplied unless noted otherwise. The installer is responsible for supplying appropriate anchors.
- The product depicted in these installation instructions may not match the product supplied, however the installation process is the same.

# Table of Contents

|   |         |
|---|---------|
| Definitions / Abbreviations .....                           | 2       |
| Canopy Assembly Overview and Component Identification ..... | 3       |
| Mounting Bracket Anchorage .....                            | 4       |
| Canopy Skeleton Unit Installation .....                     | 5 - 6   |
| Gutter Installation .....                                   | 7 - 8   |
| Top Panel Installation .....                                | 9 - 10  |
| Bottom Panel Installation .....                             | 11 - 12 |

# Definitions / Abbreviations

## **-Bottom Panel**

The component which covers the lower surface of the canopy.

## **-Fascia**

The outer most component spanning between outriggers.

## **-Gutter**

A trough positioned at the edge of the top panel for carrying off rainwater.

## **-Mounting Bracket**

The component joining the canopy outriggers to the building structure.

## **-Outrigger**

The component carrying the panel support tubes and fascia. The outrigger transfers loading to the mounting bracket.

## **-Panel Support Tube**

The component which spans between outriggers and supports the bottom panel and top panel.

## **-Splice Cover**

A part which covers a transition or discontinuity in adjacent components.

## **-Top Panel**

The component which covers the upper surface of the canopy.

# Canopy Assembly Overview

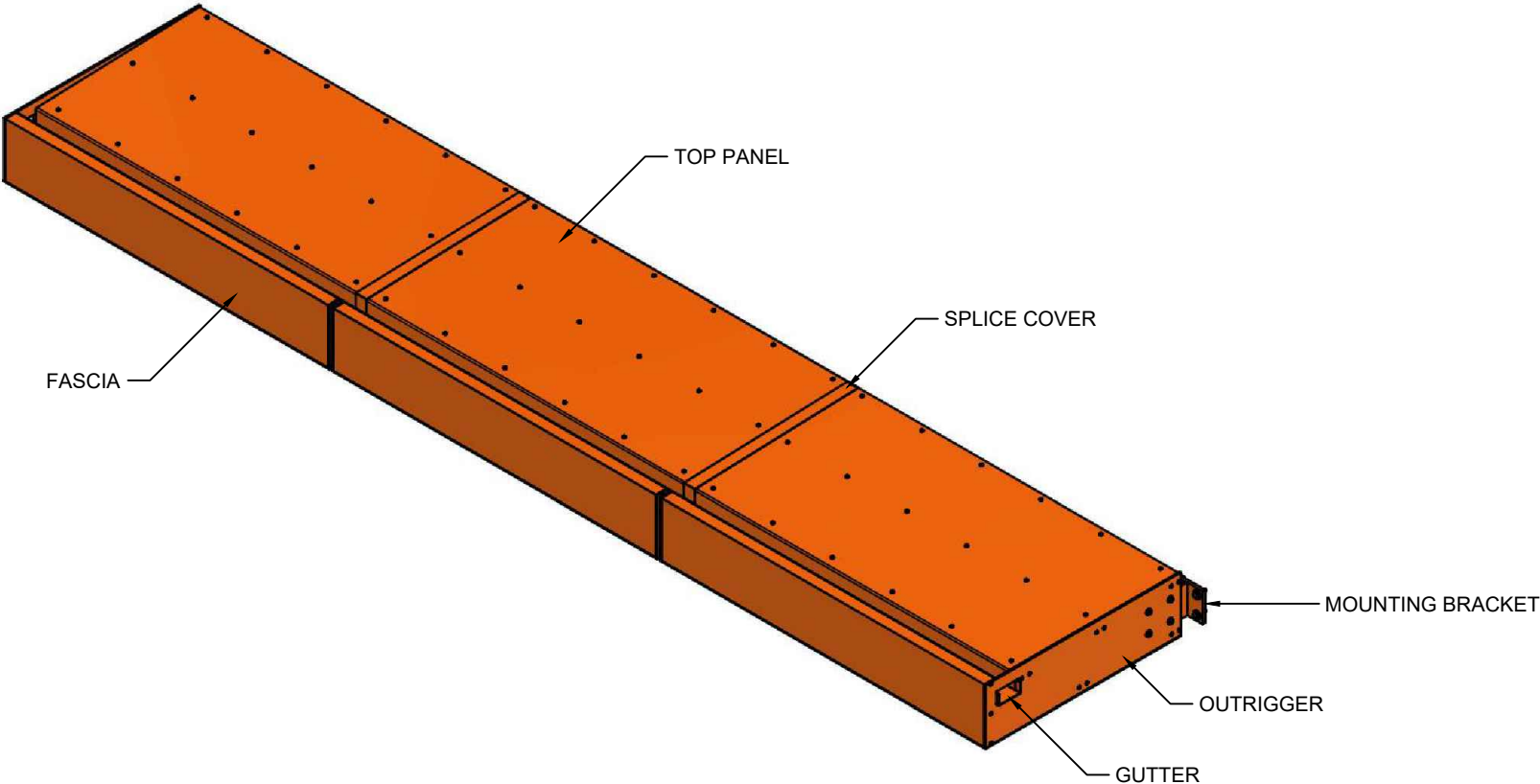

## Mounting Bracket Anchorage

1. Make marks at proper elevation for the top and/or bottom of the mounting brackets.
  - Consult the Industrial Louvers prepared submittal drawings and the architectural drawings to determine proper elevation.
2. Snap horizontal lines at marks made in Step 1.
3. Mark the lateral center line location for all mounting brackets.
  - Consult the Industrial Louvers prepared submittal drawings for bracket spacing.
4. Drill pilot holes for anchors.
  - Consult anchor manufacturer's product data for proper substrate preparation.
  - Use mounting bracket as a template.
5. Install anchors per anchor manufacturer's recommendations.

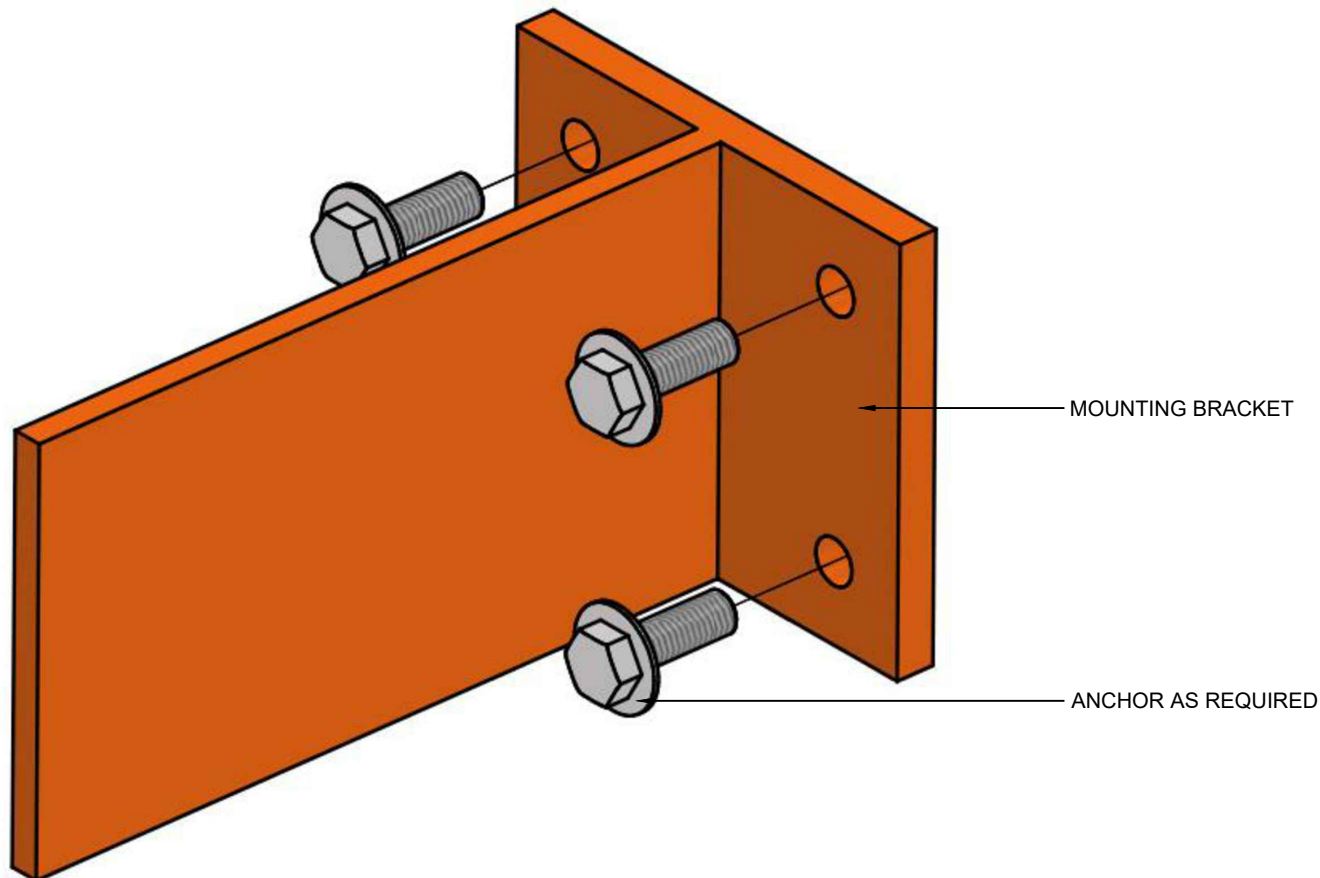

# Canopy Skeleton Unit Installation

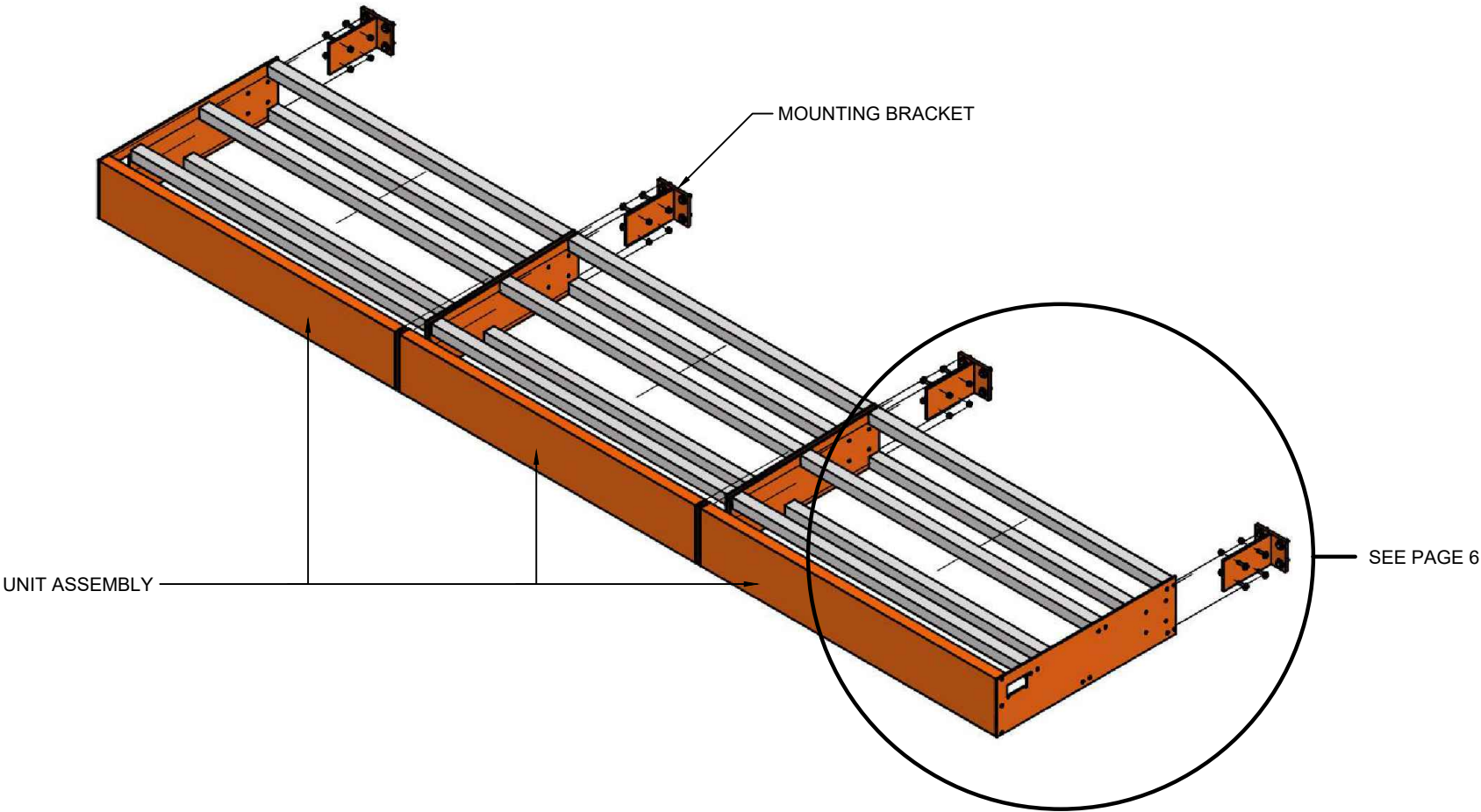

## Canopy Skeleton Unit Installation Cont.

1. Position canopy skeleton units appropriately.
  - Make sure unit is level.
  - Unit must be situated at the correct projection.
  - Unit must be situated at the correct elevation.
2. Match drill holes in canopy outriggers thru mounting bracket knife plate.
  - Drill tight fit clearance holes to prevent excessive sag.
3. Install thru bolts.

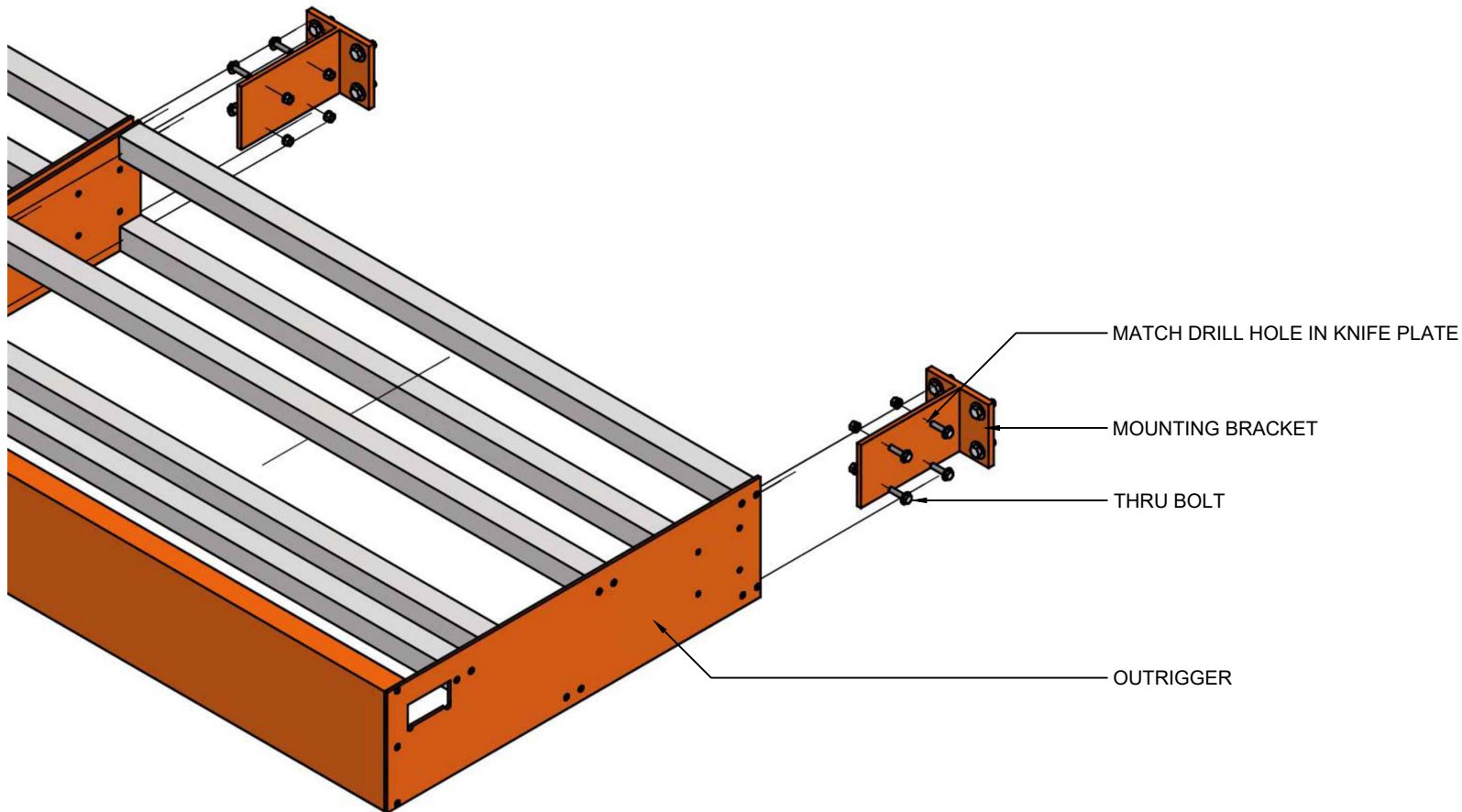

Gutter Installation

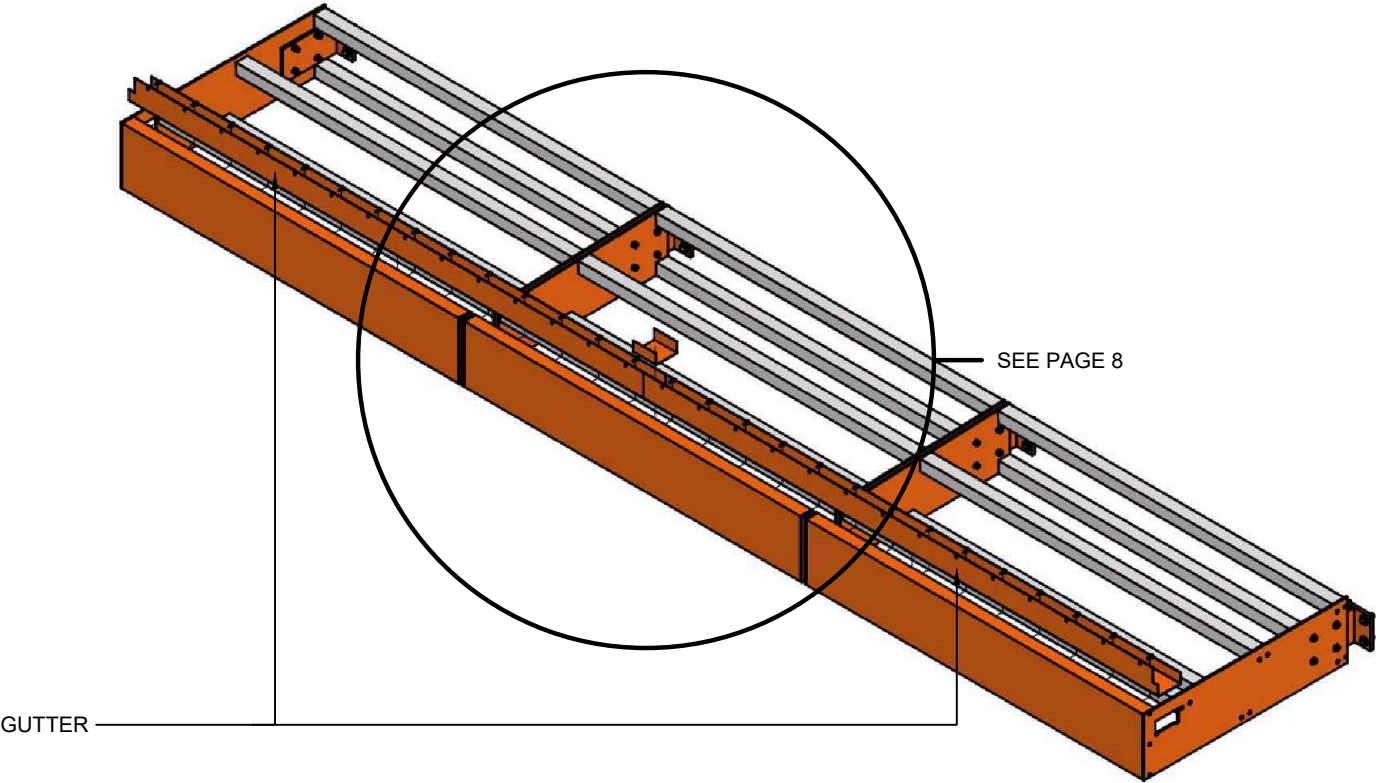



## Gutter Installation Cont.

1. Place gutter into position behind fascia.
2. Drill pilot holes as necessary into fascia using gutter as a template.
3. Fasten gutter to fascia with sheet metal screws according to the Industrial Louvers prepared submittal drawings.
4. At each gutter splice install a splice cover. Splice covers shall be set in a bed of sealant. Sealant supplied by the installer.

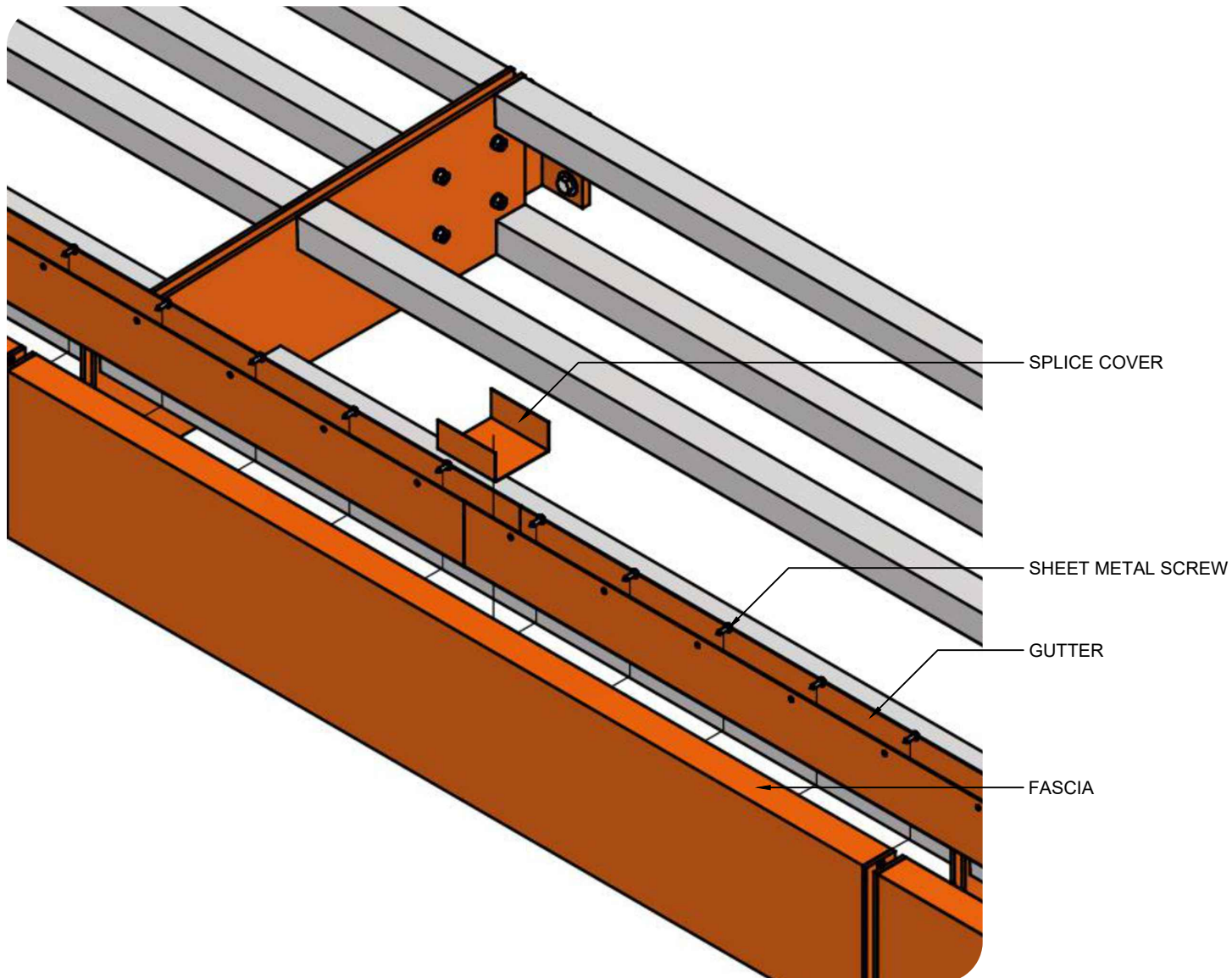



Top Panel Installation

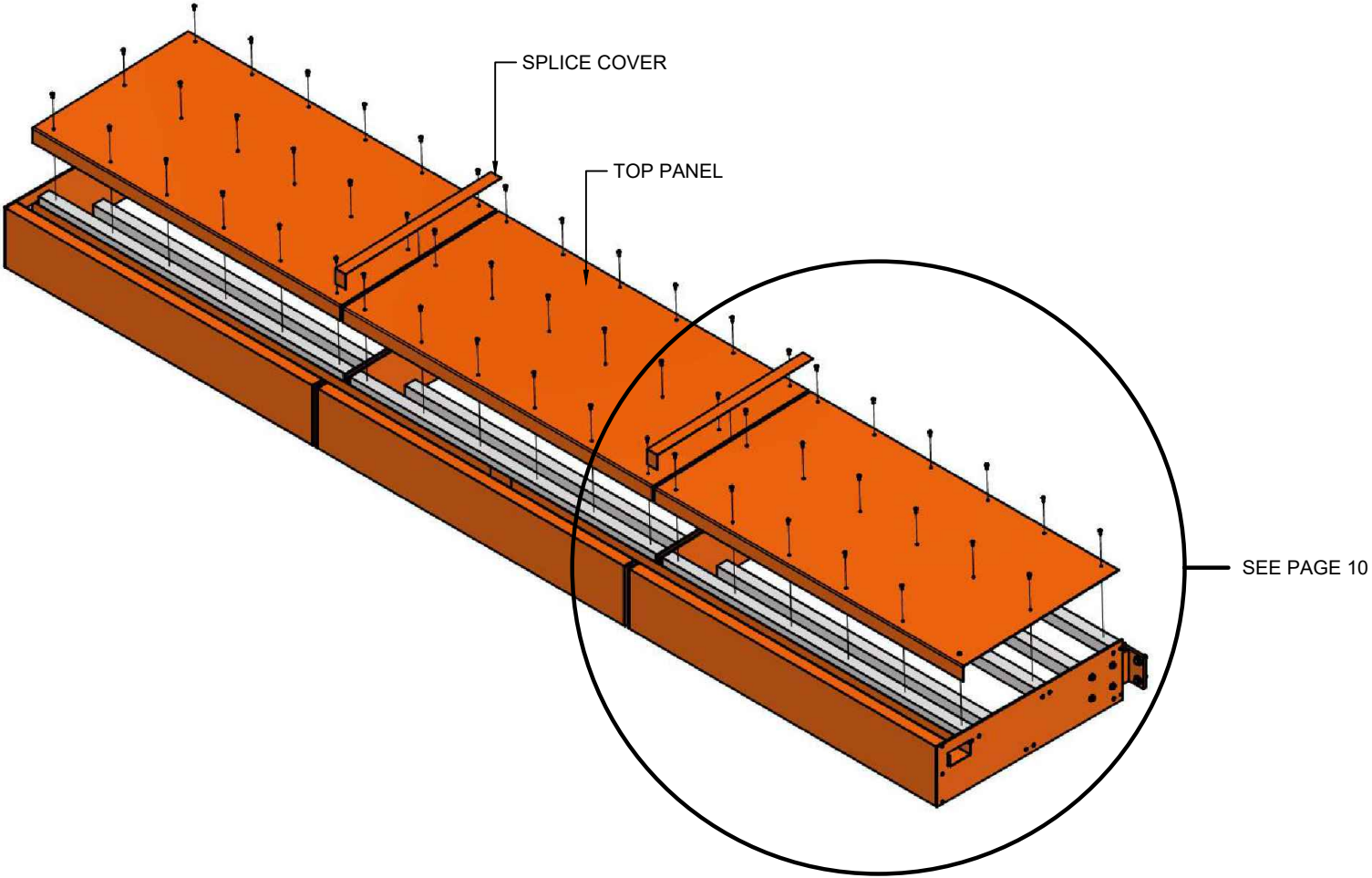

## Top Panel Installation Cont.

1. Place top panel into position.
2. Drill pilot holes as necessary into support tubes using top panel as a template.
3. Fasten top panel to support tubes with sheet metal screws according to the Industrial Louvers prepared submittal drawings.
4. At each top panel splice install a splice cover. Splice covers shall be set in a bed of sealant. Sealant supplied by the installer.

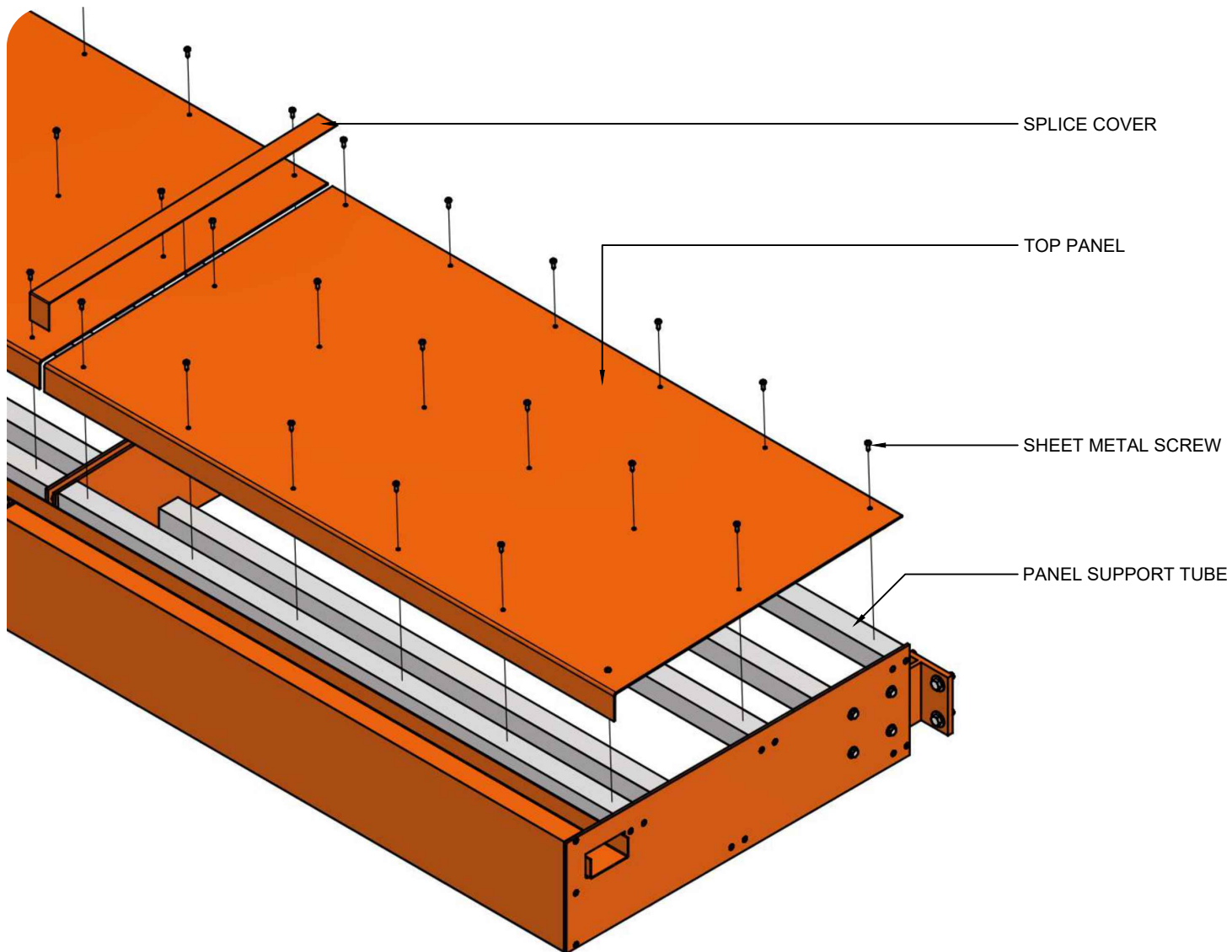

Bottom Panel Installation

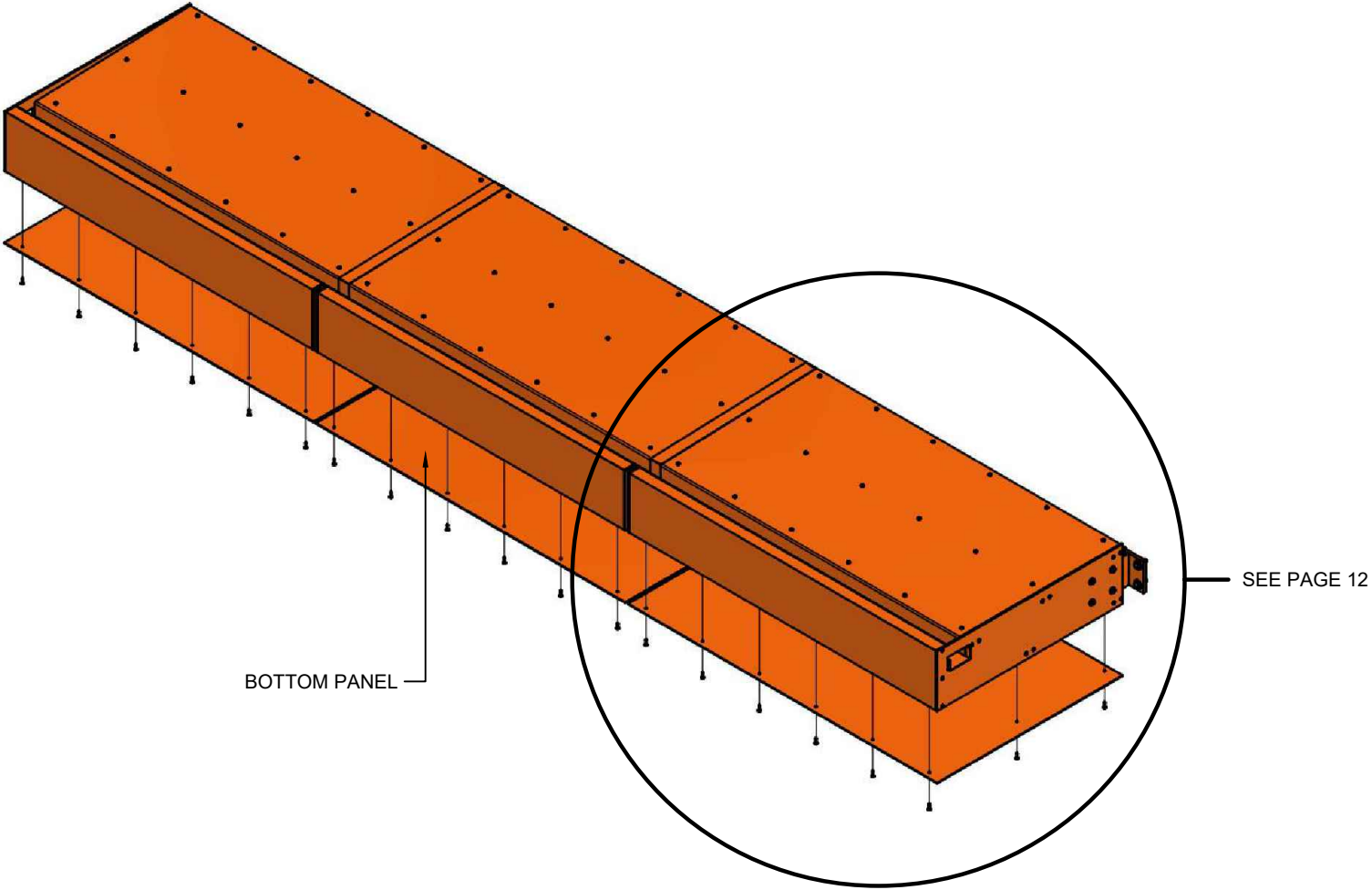

## Bottom Panel Installation Cont.

1. Place bottom panel into position.
  - Provide consistent offset from edge of unit assembly and edge of bottom panel.
2. Drill pilot holes as necessary into support tubes and fascia using bottom panel as a template.
3. Fasten bottom panel to support tubes and fascia with sheet metal screws according to the Industrial Louvers prepared submittal drawings.

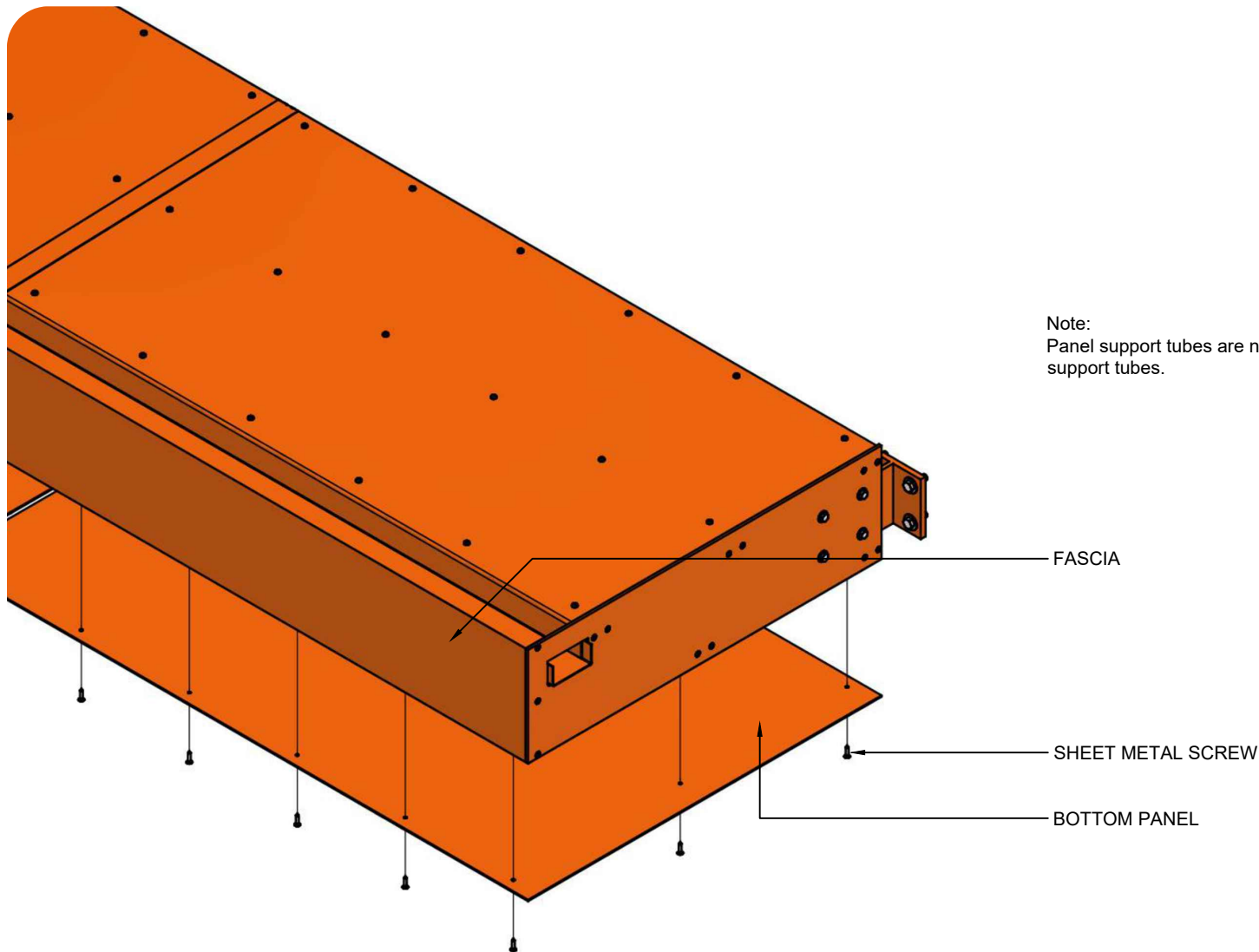

Note:  
Panel support tubes are not visible on this page. See Page 10 for image of support tubes.